

LAND AVAILABLE

# GATEWAY BOULEVARD

HEBRON, KY 41048

ZONING: INDUSTRIAL 1/ PD

**9.9 ACRES**



## PROPERTY HIGHLIGHTS

- Located adjacent to the Cincinnati/Northern Kentucky International Airport
- Easy interstate access, close to lodging and restaurants
- Sites are flat and utilities are to the site
- No city earnings tax!

## IDEAL USES

- Distribution
- Assembly
- Manufacturing

**BRETT LOWERY**

859.292.5548 office 937.974.5631 cell [blowery@corporex.com](mailto:blowery@corporex.com)

[www.corporex.com](http://www.corporex.com)

**Corporex**  
CELEBRATING 50 YEARS

LAND AVAILABLE

# GATEWAY BOULEVARD

HEBRON, KY 41048

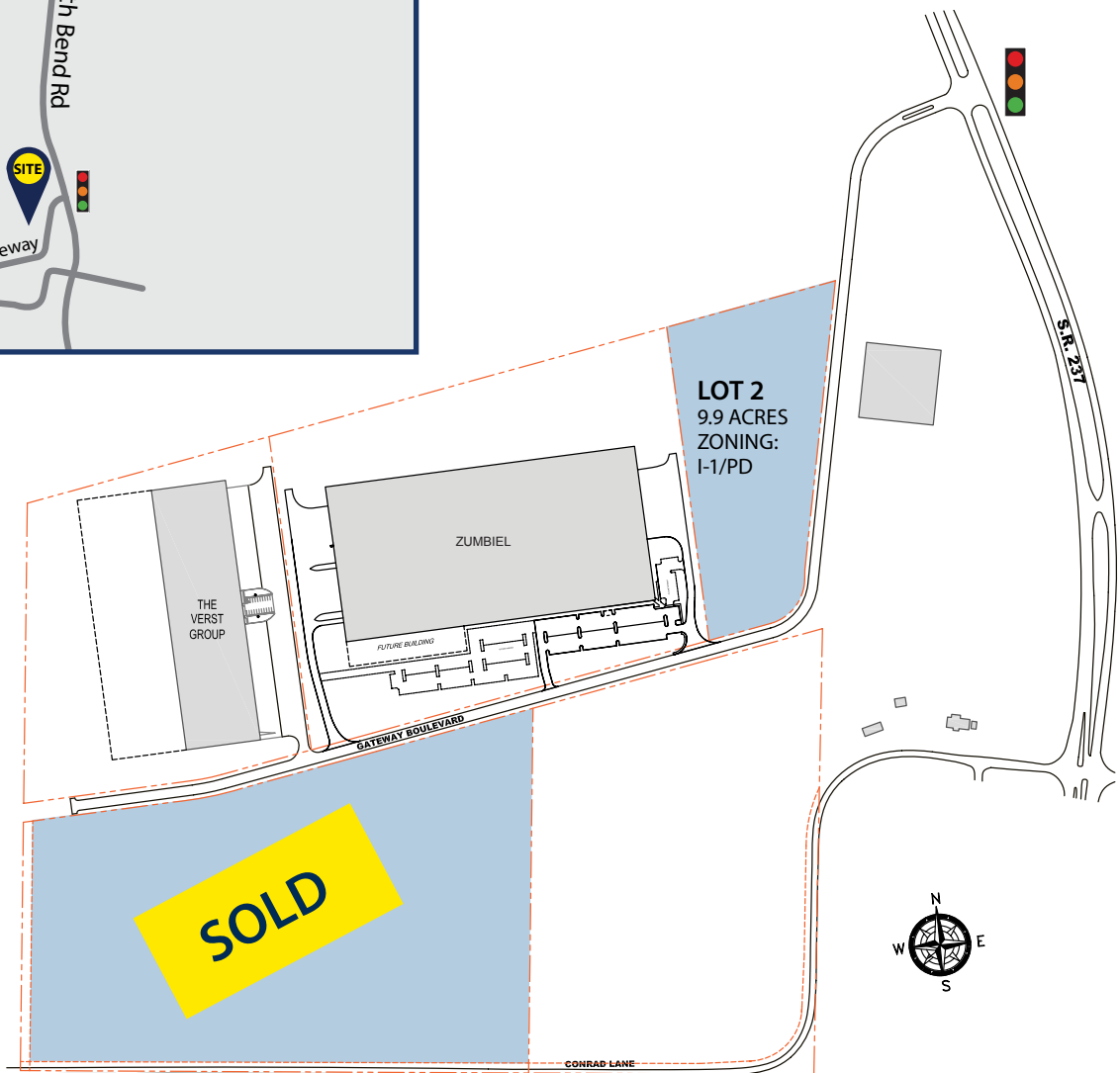

**BRETT LOWERY**  
859.292.5548 office 937.974.5631 cell [blowery@corporex.com](mailto:blowery@corporex.com)  
[www.corporex.com](http://www.corporex.com)

